



PRODUCT INFORMATION

[Download Files](#)

[3D Render](#)

USAGE

Flexibility ☐

Strength ☒

Cardio ☐

Circuit ☒

SPECIFICATIONS

FALL HEIGHT	1300mm
PRODUCT DIMENSIONS	L 2.7m x W 2.4m x H 2.7m
TOTAL SPACE REQUIRED	24.1m ² (5.6m x 5.3m)

TECHNICAL INFORMATION

AUS STANDARDS COMPLIANCE	AS4685
ASSEMBLY TIME	3 hrs
TOTAL WEIGHT	405 kg
HEAVIEST COMPONENT	61 kg
CONCRETE REQUIRED	0.6 m ³
NUMBER OF FOOTINGS	6

TOP VIEW

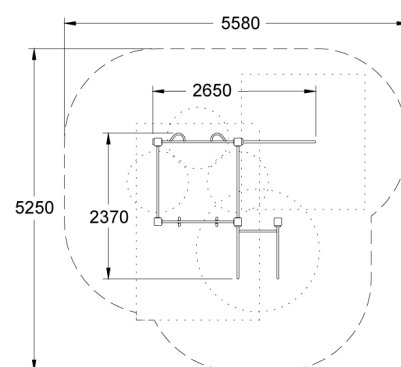

SIDE ELEVATION

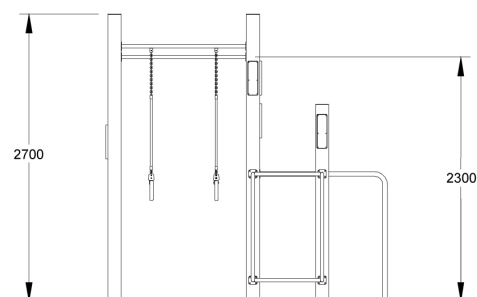

[WARRANTY](#)



[CARE PLAN](#)



[AUS MADE](#)