



URBANFIT **ACTIVO**



UFE - 6210 CROSSTRAINER



PRODUCT INFORMATION

[Download Files](#)

[3D Render](#)

USAGE

Flexibility ☐

Strength ☐

Cardio ☒

Circuit ☐

SPECIFICATIONS

FALL HEIGHT	240mm
PRODUCT DIMENSIONS	L 2.2m x W 0.5m x H 1.9m
TOTAL SPACE REQUIRED	15m ² (5.1m x 3.5m)

TECHNICAL INFORMATION

AUS STANDARDS COMPLIANCE	AS4685
ASSEMBLY TIME	2 hrs
TOTAL WEIGHT	99 kg
HEAVIEST COMPONENT	42 kg
CONCRETE REQUIRED	0.3 m ³
NUMBER OF FOOTINGS	2

TOP VIEW

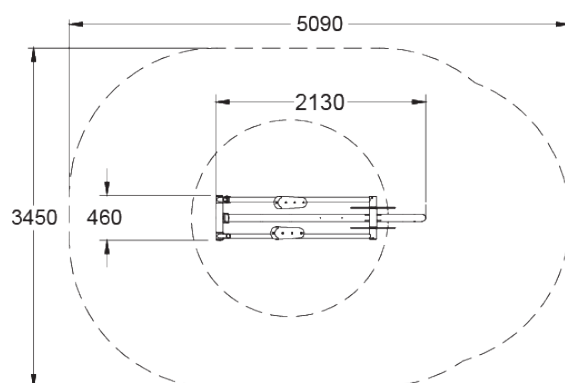

SIDE ELEVATION

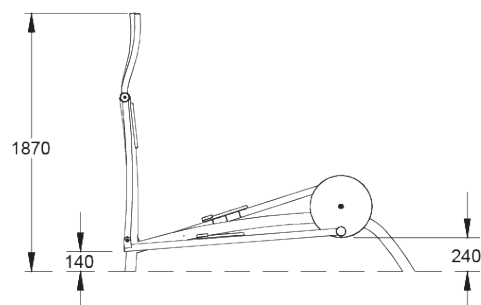

[WARRANTY](#)



[CARE PLAN](#)



[AUS MADE](#)