



URBANFIT **ACTIVO**



UFE - 6202

LAT PULL-DOWN



PRODUCT INFORMATION

[Download Files](#)[3D Render](#)

USAGE

Flexibility ☐

Strength ☒

Cardio ☐

Circuit ☐

SPECIFICATIONS

FALL HEIGHT	620mm
PRODUCT DIMENSIONS	L 1.1m x W 0.8m x H 2.4m
TOTAL SPACE REQUIRED	11.50m ² (4.1m x 3.8m)

TECHNICAL INFORMATION

AUS STANDARDS COMPLIANCE	AS4685
ASSEMBLY TIME	2 hrs
TOTAL WEIGHT	75 kg
HEAVIEST COMPONENT	41 kg
CONCRETE REQUIRED	0.02 m ³
NUMBER OF FOOTINGS	1

TOP VIEW

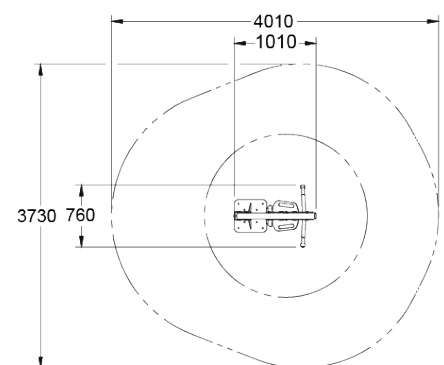

SIDE ELEVATION

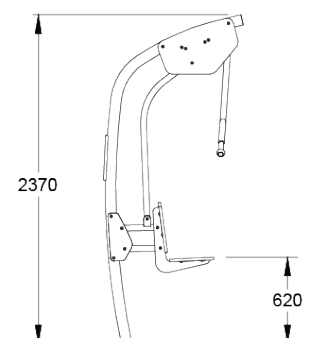
[WARRANTY](#)[CARE PLAN](#)[AUS MADE](#)