



# URBANFIT EURO



## UFE - 6205

### CARDIO WALKER



#### PRODUCT INFORMATION

[Download Files](#)[3D Render](#)

#### USAGE

Flexibility



Strength



Cardio



Circuit



## SPECIFICATIONS

|                      |                                     |
|----------------------|-------------------------------------|
| FALL HEIGHT          | 800mm                               |
| PRODUCT DIMENSIONS   | L 2.33m x W 1.25m x H 1.27m         |
| TOTAL SPACE REQUIRED | 18.50m <sup>2</sup> (5.00m x 4.10m) |

## TECHNICAL INFORMATION

|                          |                     |
|--------------------------|---------------------|
| AUS STANDARDS COMPLIANCE | AS4685              |
| ASSEMBLY TIME            | 5 hrs               |
| TOTAL WEIGHT             | 80 kg               |
| HEAVIEST COMPONENT       | 80 kg               |
| CONCRETE REQUIRED        | 0.20 m <sup>3</sup> |
| NUMBER OF FOOTINGS       | 4                   |

TOP VIEW

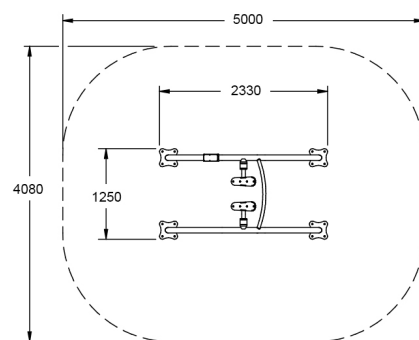

SIDE ELEVATION

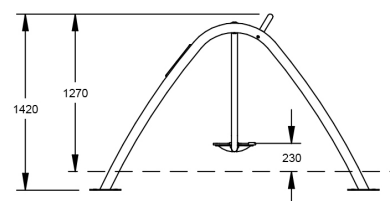
[WARRANTY](#)[CARE PLAN](#)[AUS MADE](#)